

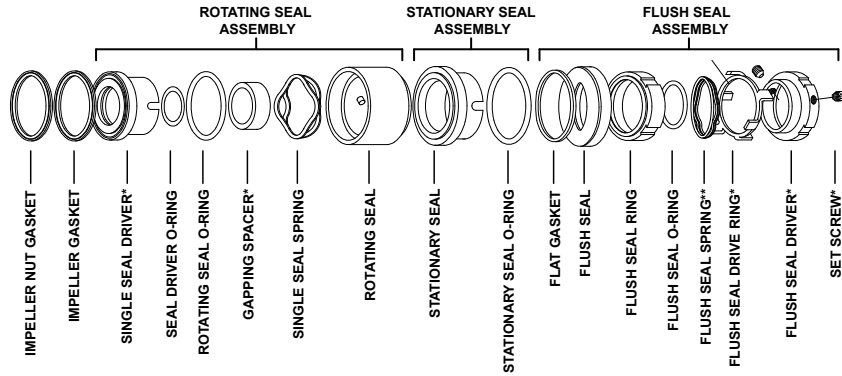

FPH/FPHP 722 & 3542 & 3552; FM3
Double Seal Assembly
Sizes: HP1, HP3

P.O. Box 620065, MIDDLETON, WI 53562
 TEL: (800)841-5001 FAX: (608)831-8467
 www.fristam.com / fristam@fristampumps.com

DWG # 1265000669 REV -
 CARD PART # 1050000265



*NOT SUPPLIED IN WEAR PARTS KIT

**FLUSH SEAL SPRING HAS A WHITE STRIPE ON THE OUTSIDE EDGE (EXCEPT MODEL 722);
 ROTATING SEAL SPRING DOES NOT

DWG # 1265000668

When replacing ANY seal part, it is important to replace ALL seal wear parts.



FPH 3642 & 3652; FM5
Double Seal Assembly
Sizes: HP4

P.O. Box 620065, MIDDLETON, WI 53562
 TEL: (800)841-5001 FAX: (608)831-8467
 www.fristam.com / fristam@fristampumps.com

DWG # 1265000670 REV -
 CARD PART # 1050000266

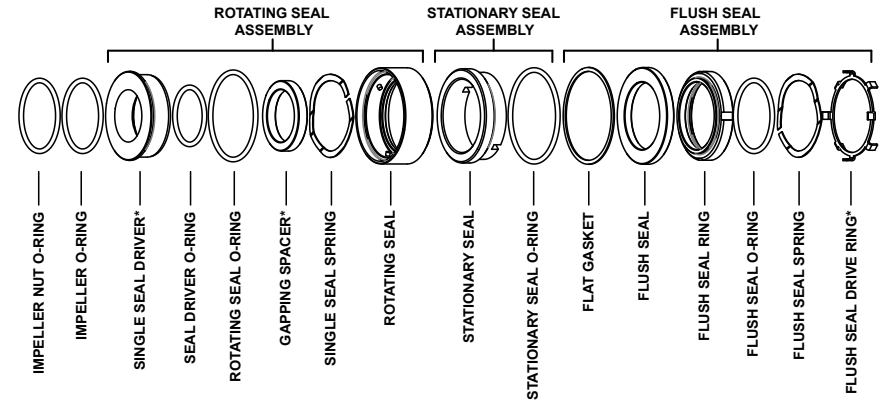

*NOT SUPPLIED IN WEAR PARTS KIT

DWG # 1265000667

When replacing ANY seal part, it is important to replace ALL seal wear parts.